

## Specification

<b>Nominal Voltage</b>	16V (8 cells)		
<b>Nominal Capacity</b>	77° F (25° C)		
20-hr. (3A)	60 Ah		
10-hr. (5.58A)	55.8 Ah		
5-hr. (10.2A)	51.0 Ah		
1-hr. (36A)	36.0 Ah		
<b>Approximate Weight</b>	50.71 lbs (23.0 kgs)		
<b>Internal Resistance (approx.)</b>	12mΩ		
<b>Shelf Life</b> (% of normal capacity at 77° F (25° C))			
3 Months	6 Months	12 Months	
91%	82%	64%	
<b>Temperature Dependency of Capacity</b>	(20 hour rate)		
104° F	77° F	32° F	5° F
102%	100%	85%	65%



## Charge Method (Constant Voltage)

### Cycle Use (Repeating Use)

Initial Current	18 A or smaller
Control Voltage	19.2 - 19.8 V

### Float Use

Control Voltage	18.2 - 18.4 V
-----------------	---------------

## Physical Dimensions: in (mm)

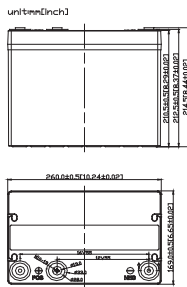

**L:** 10.24in (260 mm)  
**W:** 6.65in (169 mm)  
**H:** 8.37in (212.5 mm)  
**TH:** 8.44in (214.5 mm)

Tolerances are +/- 0.04 in. (+/- 1mm) and +/- 0.08 in. (+/- 2mm) for height dimensions. All data subject to change without notice.

## Terminals

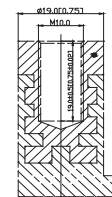

## Battery Charging Characteristics for Cyclic Use

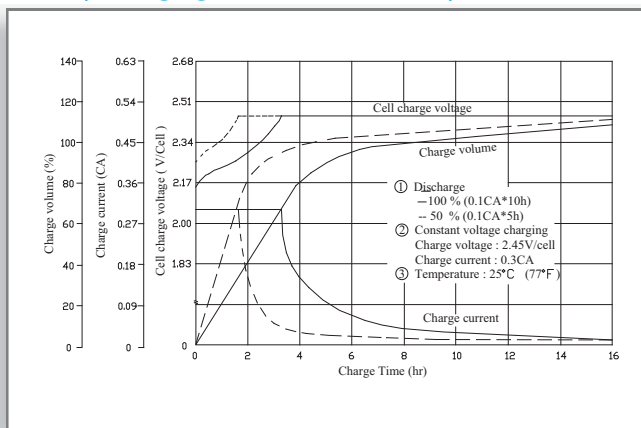

## Battery Charging Characteristics for Standby Use

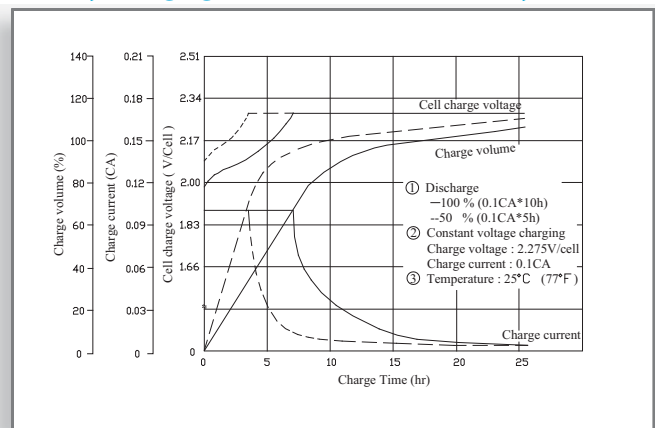

# UB16600

Maintenance-Free

## Discharge Time vs. Discharge Current

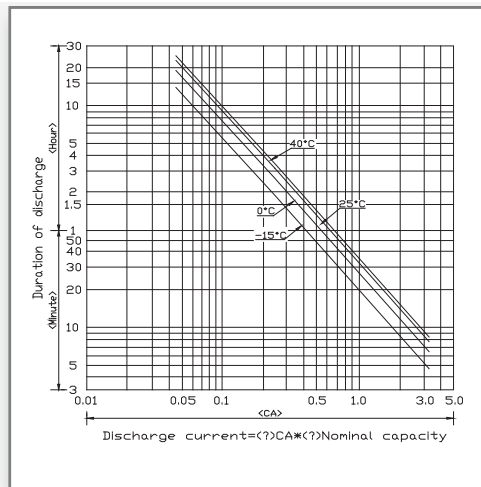

## Discharge Characteristics

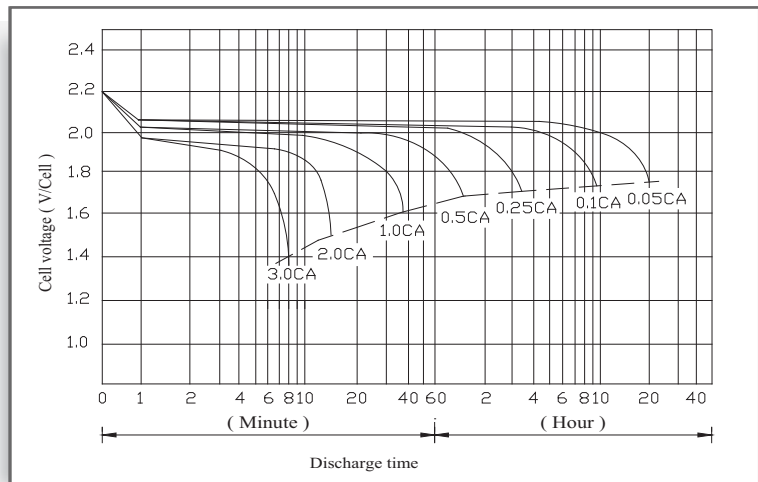

## Shelf Life & Storage

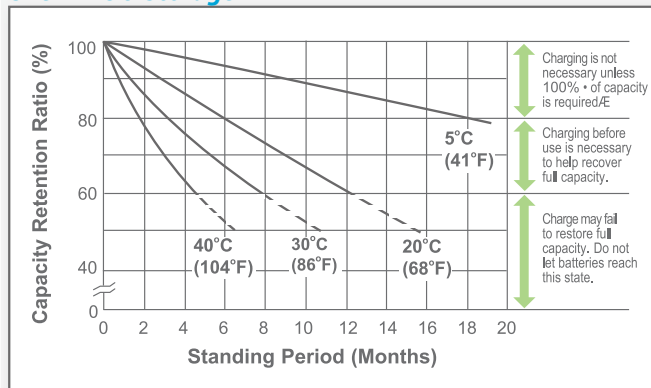

## Cycle Life vs Depth of Discharge

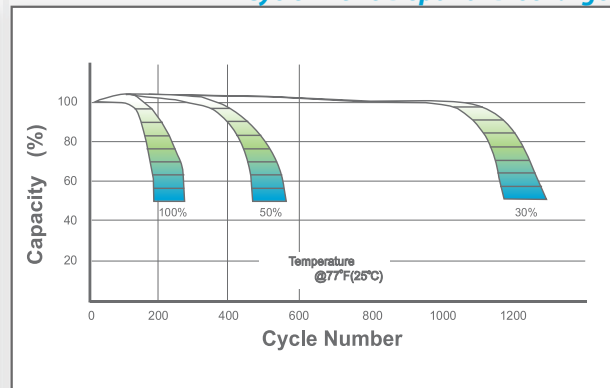

## Effect of Temperature on Capacity

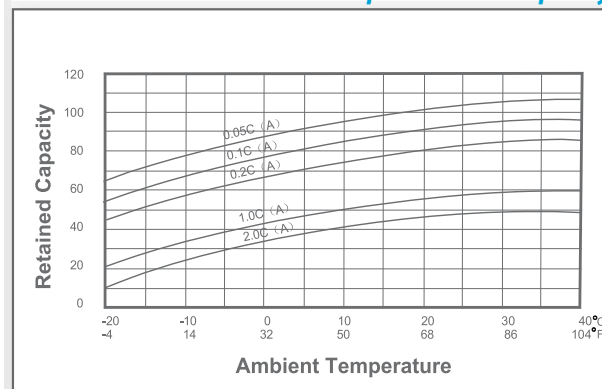

## Charge Current & Final Discharge Voltage

Application	Charge Voltage(V/Cell)			Max.Charge Current	Final Discharge Voltage V/Cell	1.75	1.70	1.60	1.30
	Temperature	Set Point	Allowable Range						
Cycle Use	25°C(77°F)	2.45	2.40~2.50	0.30C	Discharge Current(A)	0.2C>(A)	0.2C<(A)<0.5C	0.5C<(A)<1.0C	(A)>1.0C
Standby	25°C(77°F)	2.325	2.30~2.35						